

# HOW TO ASSY OF SCS3 AND SCS6

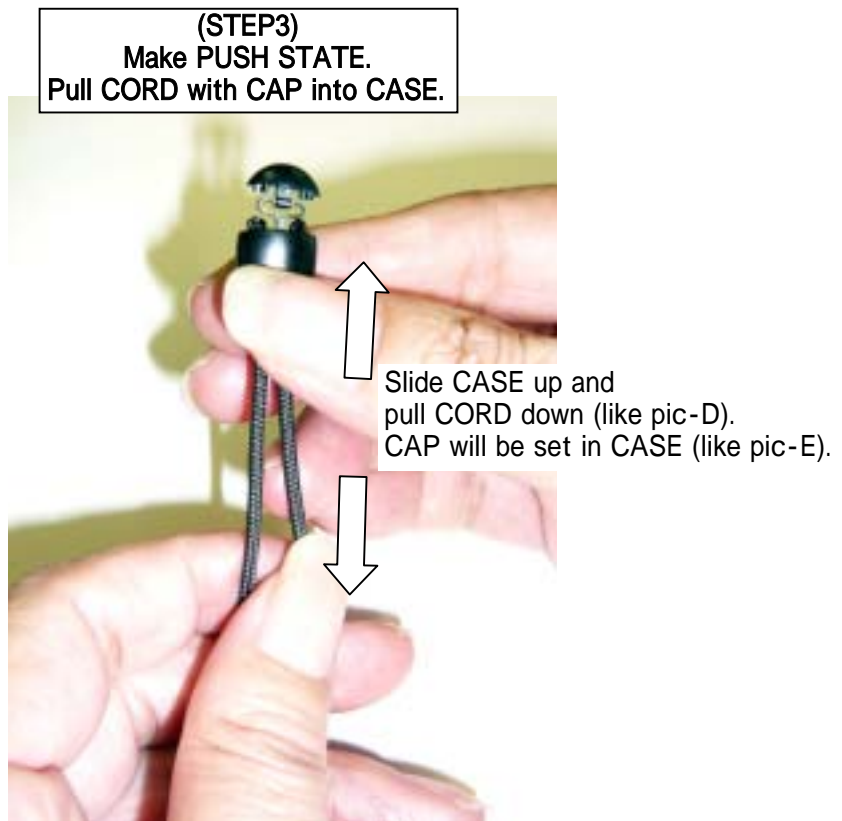
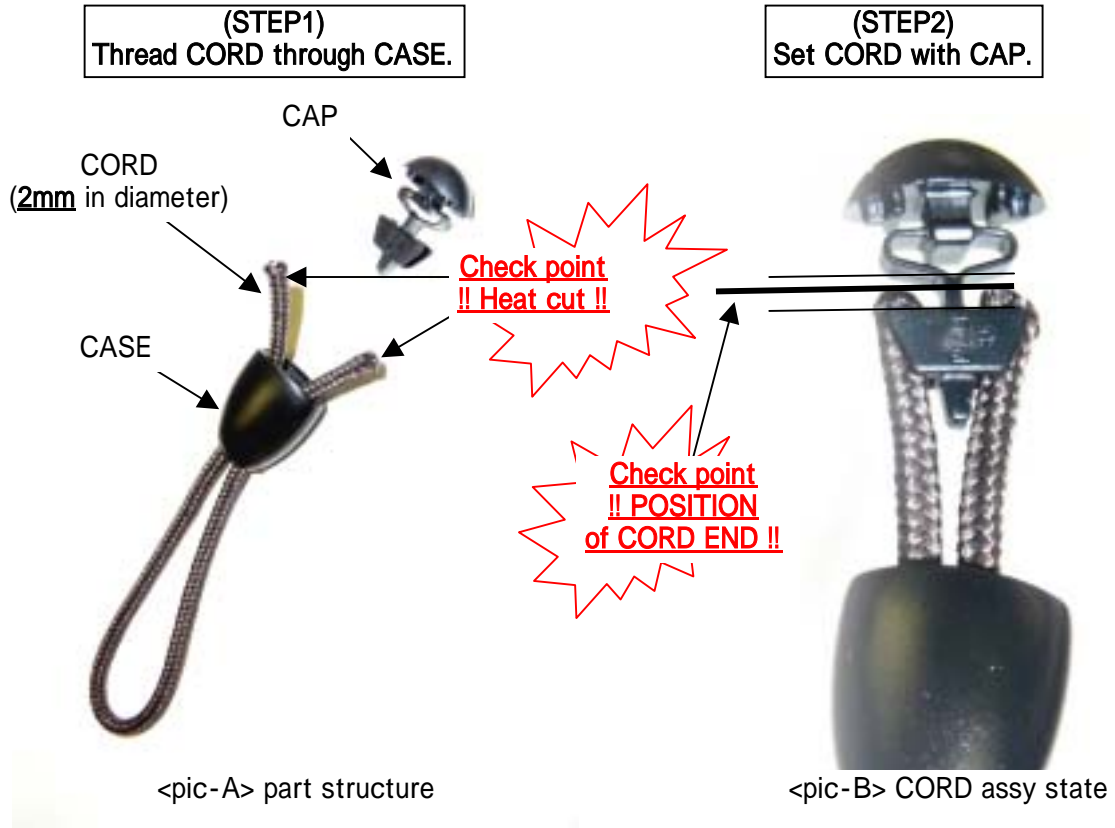

<pic-D> CAP set assy state

# HOW TO ASSY OF SCS3 AND SCS6

(STEP4)  
Make COMPLETION STATE.  
Push CAP into CASE to lock.

↓ Push CAP in (like pic-E).



<pic-E> PUSH state

(STEP5)  
Check COMPLETION STATE.

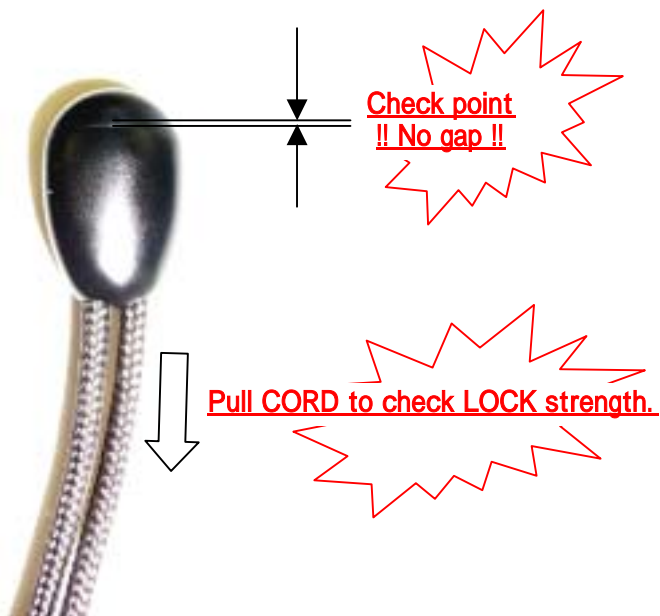

<pic-E> COMPLETION STATE